

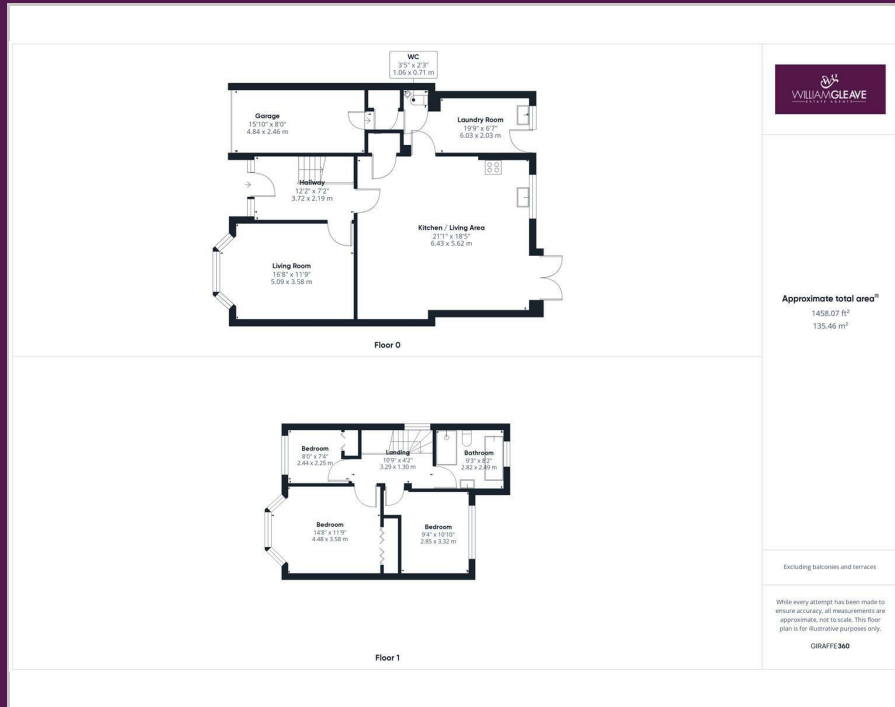

79 Borrass Road, Wrexham, LL12 7EW
£1,400 Per Month

Floor Plan



Area Map

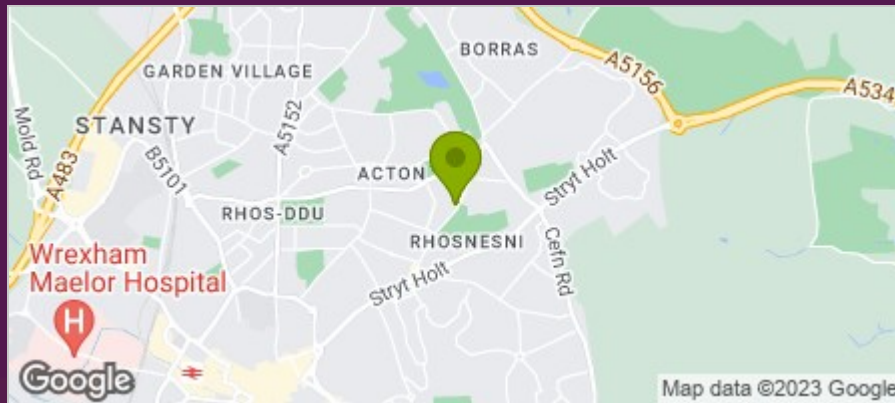

These particulars, whilst believed to be accurate are set out as a general outline only for guidance and do not constitute any part of an offer or contract. Intending purchasers should not rely on them as statements of representation of fact, but must satisfy themselves by inspection or otherwise as to their accuracy. No person in this firm's employment has the authority to make or give any representation or warranty in respect of the property.

Accommodation

- Available Late November
- Large Open Plan Kitchen, Dining Area & Lounge
- Separate Lounge To Front
- Three Bedrooms
- Large Enclosed Rear Garden
- Modern Décor Throughout
- Unfurnished Property
- EPC Rating - D

Viewing

Please contact our William Gleave Deeside Office on 01244 830000 if you wish to arrange a viewing appointment for this property or require further information.

Energy Efficiency Graph

